



Hyde Road | Woodley
Price Guide £230,000

Bedrooms 2

Bath 2

Reception 1

Parking here

Area
1178.00 sq ft

Chain Free

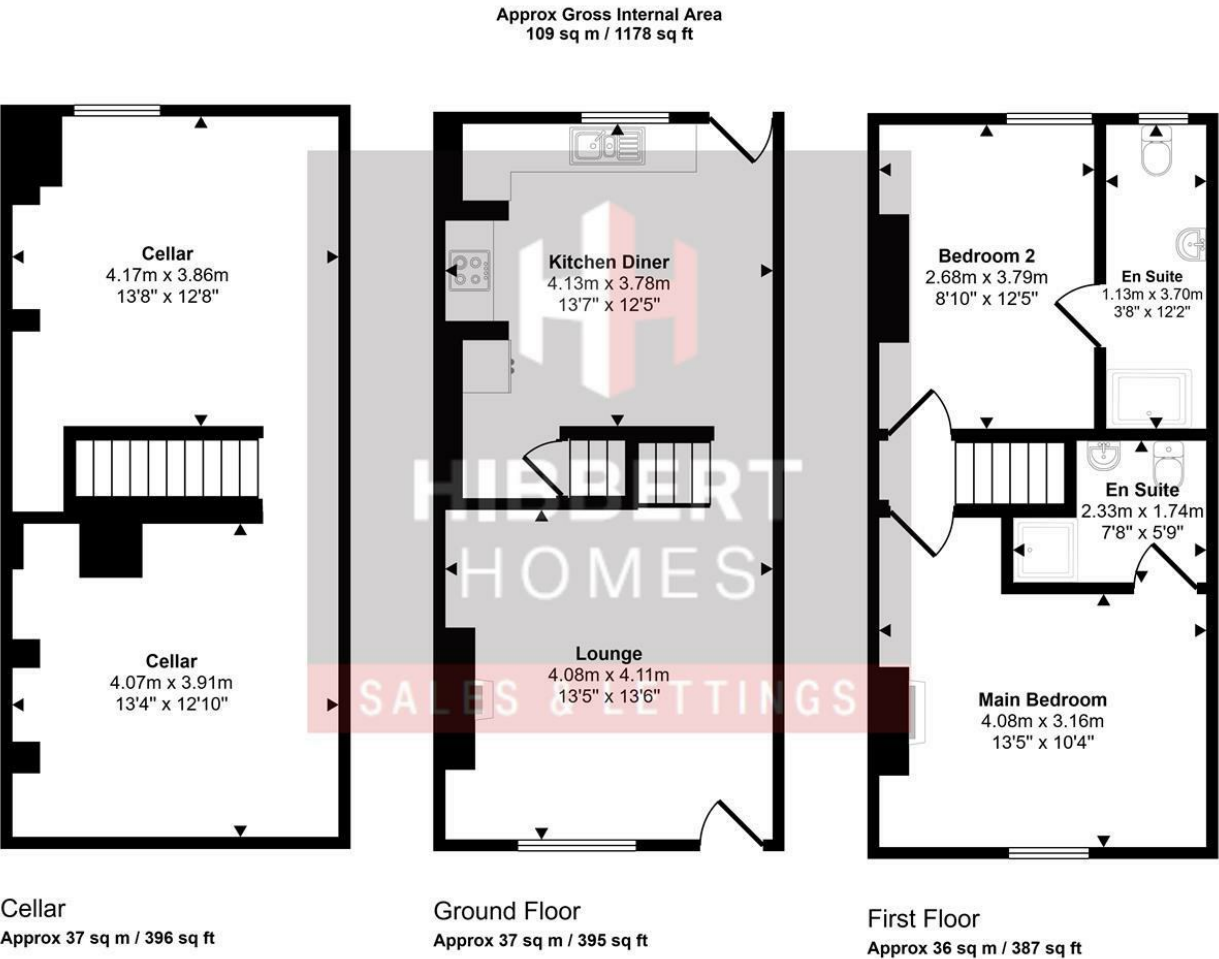

This floorplan is only for illustrative purposes and is not to scale. Measurements of rooms, doors, windows, and any items are approximate and no responsibility is taken for any error, omission or mis-statement. Icons of items such as bathroom suites are representations only and may not look like the real items. Made with Made Snappy 360.

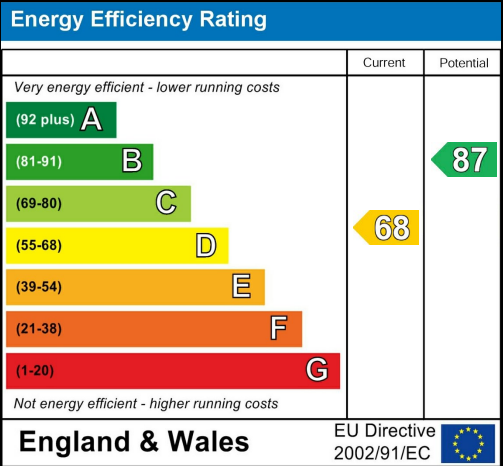

SALES & LETTINGS

21 Bramhall Lane South | Bramhall | SK7 1AL
t: 0161 480 0099
e: enquiries@hibberthomes.com
www.hibberthomes.com

- CHAIN FREE
- MODERN KITCHEN
- EN SUITES IN BOTH BEDROOMS
- RECENTLY REFURBISHED
- TWO DOUBLE BEDROOMS
- CONVERTED OUT BUILDING

Hibbert Homes are pleased to present this recently refurbished Two Bedroom terraced property to the market, located on Hyde Road, Woodley. This property has been completely refurbished by the current owner and offers modern character throughout. This property offers excellent convenience to Woodley Train Station, and is also very local to Romiley Village too.

Hyde Road briefly comprises from a large and inviting living room upon entrance, heading into a bespoke kitchen featuring state-of-the-art integrated appliances, with access to the rear garden located here too. A double basement is included with this property, creating ideal storage space. Heading upstairs, this home features two double bedrooms, both inclusive of highly modernised en-suite shower rooms.

A detached outbuilding at the rear of the property creates a brilliant spot for a potential office, or entertainment spot when hosting guests. A low maintenance rear garden is also found at the rear of the property.

This property is sold CHAIN FREE! Contact Hibbert Homes Bramhall on 0161 480 0099 to book your viewing today.

